

LOW PRESSURE STAINLESS STEEL COUPLING, 050 - NOMINAL FLOW DIAMETER 2,7- STAINLESS STEEL

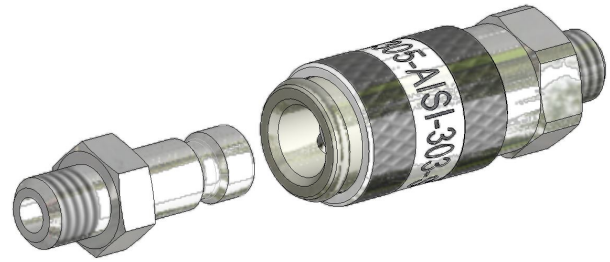

TECHNIQUE

Single-handed coupling with automatic 3-point locking. Locking elements are balls that are locked by a spring-loaded release sleeve. The uncoupling process is started by pushing the release sleeve back in the direction of the connection. The valve returns to its original position and pushes the plug connector out of the coupling.

ANWENDUNGSBEREICHE

- medical technology
- general industrial supplies
- double shut off
- stainless steel/steel

PRESSURE RANGE

The coupling can be statically loaded up to 35 bar without pulsation.

MATERIALS COUPLING

Connection, basic body, release sleeve and valve AISI 303
 Pressure springs and retaining rings AISI 302
 Balls AISI 420

MATERIALS GASKET

Seals made of fluorine elastomer (FPM)
 Hardness of material 70 Shore
 Temperature range -25°C through +200°C
 Temperature range -25°C through +300°C (allowed for short periods)
 Gas permeability coefficient (Ø)= 3
 Resistant to mineral oils, fuels, chlorinated hydrocarbons, synthetic hydraulic fluids, hot air and many chemicals (on request)

MATERIALS CONNECTION

Plug connector AISI 303

LOW PRESSURE STAINLESS STEEL COUPLING, 050 - NOMINAL FLOW DIAMETER 2,7- STAINLESS STEEL

HOSE TAIL COUPLING

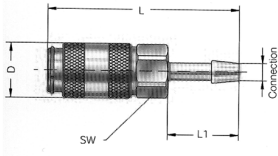

Connection	D	L	L1	SW	Order number
LW3	10	21	13	8	050.00.KV0N.ST003.30V
LW4	10	21	13	8	050.00.KV0N.ST004.30V

MALE COUPLING

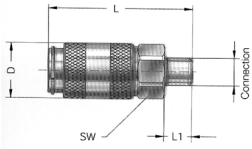

Connection	D	L	L1	SW	Order number
M5	10	21,7	4,3	9	050.00.KV0N.AM005.30V
G1/8	10	21,5	6,5	11	050.00.KV0N.AG018.30V

FEMALE COUPLING

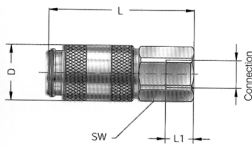

Connection	D	L	L1	SW	Order number
M5	10	26	5	9	050.00.KV0N.IM005.30V
G1/8	10	28	6,5	12	050.00.KV0N.IG018.30V

QUICK FIT TUBE CONNECTION COUPLING

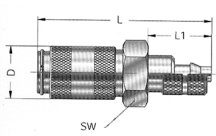

Connection	D	L	L1	SW	SW1	Order number
3x4	10	21	12	9	8	050.00.KV0N.SV004.30V
3x5	10	21	12	9	8	050.00.KV0N.SV005.30V
4x6	10	21	12	9	9	050.00.KV0N.SV006.30V

FEMALE PLUG

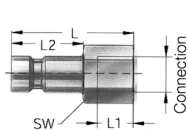

Connection	L	L1	SW	Order number
M5	17	5	7	050.00.S000.IM005.300
G1/8	19	6,5	12	050.00.S000.IG018.300

LOW PRESSURE STAINLESS STEEL COUPLING, 050 - NOMINAL FLOW DIAMETER 2,7- STAINLESS STEEL

MALE PLUG

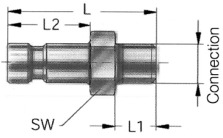

Connection	L	L1	SW	Order number
M5	13	5	7	050.00.S000.AM005.300
G1/8	13	7	11	050.00.S000.AG018.300

HOSE TAIL PLUG

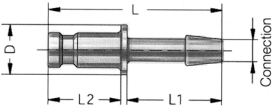

Connection	L	L1	Order number
LW3	11	13	050.00.S000.ST003.300
LW4	11	13	050.00.S000.ST004.300
LW5	11	13	050.00.S000.ST005.300