

LOW PRESSURE COUPLING, 152 - NOMINAL FLOW DIAMETER 10 - STAINLESS STEEL

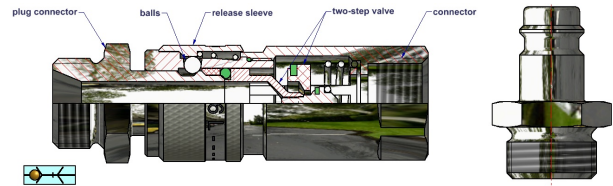

TECHNIQUE

Single-handed coupling with automatic 6-point lock with balls. The coupling process is started by pushing the plug connector in until the balls engage audibly. The uncoupling process is started by pushing the release sleeve back in the direction of the connection. The valve returns to its original position. Advantage of this double stage valve is the low bonding force of plug connector and coupling.

ANWENDUNGSBEREICHE

- medical technology
- general industrial supplies
- stainless steel/steel

PRESSURE RANGE

The coupling can be statically loaded up to 35 bar without pulsation.

MATERIALS COUPLING

Basic body, release sleeve, connection, valve AISI 316L-electropolished
 Pressure springs AISI 316Ti
 Balls AISI 316

MATERIALS GASKET

Seals made of fluorine elastomer (FPM)
 Hardness of material 70 Shore
 Temperature range -25°C through +200°C
 Temperature range -25°C through +300°C (allowed for short periods)
 Gas permeability coefficient (Ø)= 3
 Resistant to mineral oils, fuels, chlorinated hydrocarbons, synthetic hydraulic fluids, hot air and many chemicals (on request)

MATERIALS CONNECTION

Plug connector AISI 316L-electropolished

LOW PRESSURE COUPLING, 152 - NOMINAL FLOW DIAMETER 10 - STAINLESS STEEL

FEMALE COUPLING

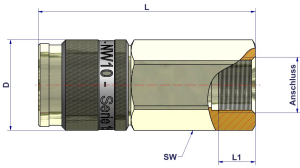

Connection	L	L1	D	SW	Order number
G1/4			27	24	152.00.KV0N.IG014.4EV
G3/8			27	24	152.00.KV0N.IG038.4EV
G1/2	66	12	27	24	152.00.KV0N.IG012.4EV
G3/4	70	16	27	32	152.00.KV0N.IG034.4EV

MALE COUPLING

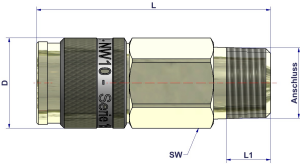

Connection	L	L1	D	SW	Order number
G1/4			27	24	152.00.KV0N.AG014.4EV
G3/8			27	24	152.00.KV0N.AG038.4EV
G1/2			27	24	152.00.KV0N.AG012.4EV
G3/4			27	27	152.00.KV0N.AG034.4EV

HOSE TAIL COUPLING

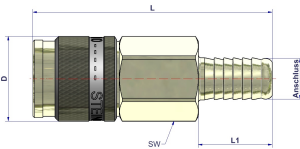

Connection	L	L1	D	SW	Order number
LW13			27	24	152.00.KV0N.ST013.4EV

FEMALE PLUG

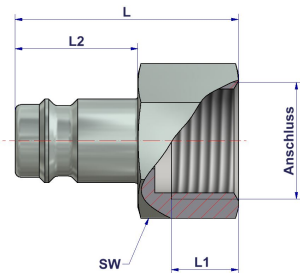

Connection	L	L1	L2	SW	Order number
G1/4			22		152.00.S000.IG014.4EV
G3/8			22		152.00.S000.IG038.4EV
G1/2	49	12	22	24	152.00.S000.IG012.4EV

MALE PLUG

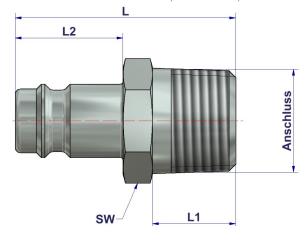

Connection	L	L1	L2	SW	Order number
G1/4			22		152.00.S000.AG014.4EV
G3/8			22		152.00.S000.AG038.4EV
G1/2	40	20	22	24	152.00.S000.AG012.4EV
G3/4			22		152.00.S000.AG034.4EV

LOW PRESSURE COUPLING, 152 - NOMINAL FLOW DIAMETER 10 - STAINLESS STEEL

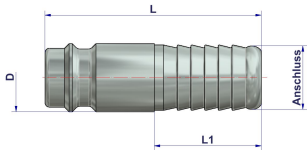

HOSE TAIL PLUG

Connection	L	L1	L2	Order number
LW9			22	152.00.S000.ST009.4EV
LW13			22	152.00.S000.ST013.4EV